

Service
Service
Service

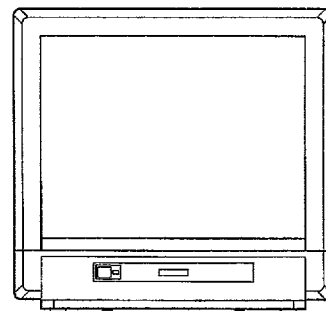

CL 26532053/022
290692

Service Manual

Safety regulations require that the set be restored to its original condition and that parts which are identical with those specified be used.

Les normes de sécurité exigent que l'appareil soit remis à l'état d'origine et que utilisés les pièces de rechange identiques à celles spécifiées.

CHASSIS ANUBIS A

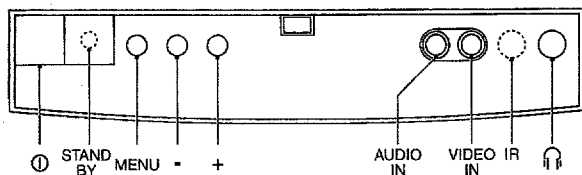

CL 26532210/015
071292

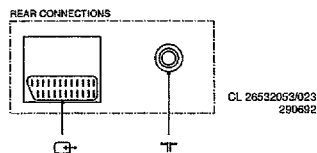

CL 26532053/023
290692

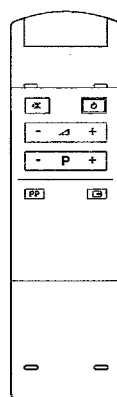

RC 9057
21AA3557

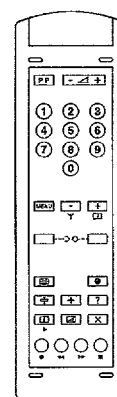

CL 26532210/012
071292

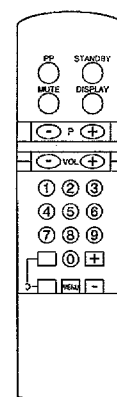

CL 26532210/013
071292

RC6803
21AA3356



220-240 V (± 10%)
52 W



A51EAM31x45
4822 131 20324



axbxc (mm)
508x475x470



1x1 W



-/00 /20 : PAL BG
-/01 /13 /21 : PAL BGI
SECAM BGLL'
-/05 /25 : PAL I
-/42 /43 : PAL BG
SECAM DK



UV917E
VHFa : 46-118 MHz
VHFb : 118-300 MHz
UHF : 470-861
U943C
Only for -/05 /25
UHF : 470-861MHz
UV915E
Only for -/01 /13 /21
VHFa : 46-118 MHz
VHFb : 118-300 MHz
Hyper : 300-470MHz
UHF : 470-861 MHz



PHILIPS

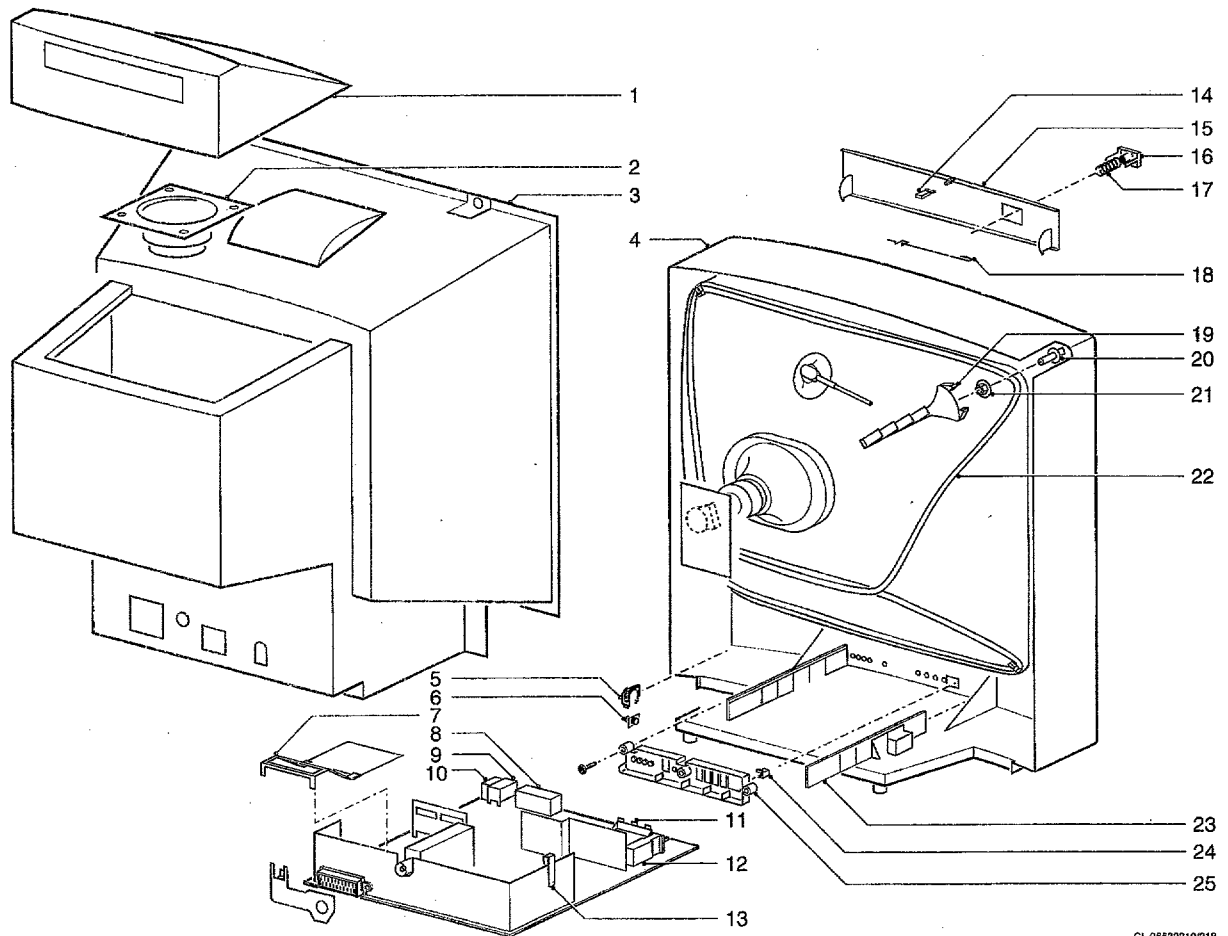

CL 28532210/018
081292

1	4822 445 10325	Loudspeaker box 21"
2	4822 240 50328	Loudspeaker
3	4822 438 10388	Rear cover 21"
4	4822 430 40219	Cabinet 21"
5	4822 462 30566	Holder for damper
6	4822 522 31741	Damper
7	4822 403 70874	TXT Bracket
8	4822 265 20626	Phono 2 fold
9	4822 218 20981	RC Receiver
10	4822 267 31292	Headphone jack
11	4822 277 21438	Switch assy left
12	4822 276 13307	Mains switch
13	4822 492 70559	Spring for transistor
14	4822 278 10088	Lock mechanism
15	4822 432 93064	Door 21"
16	4822 410 62199	Mains button
17	4822 492 32656	Spring
18	4822 492 71148	Spring for door
19	4822 404 31238	Bracket
20	4822 502 12865	Spindle
21	4822 505 10903	Nut
22	4822 157 52155	Degaussing coil 21"
23	4822 462 30557	Guide
24	4822 381 11362	LED lens
25	4822 413 41777	Button frame

4822 218
4822 218 21152

Remote control RC6803
Remote control RC9057