

Service
Service
Service

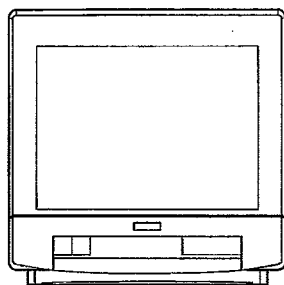

CL 26532210/016
071292

38ZZ3385/03B/08B/16B

153933PP/39B

15PT161A/05

Service Manual

Safety regulations require that the set be restored to its original condition and that parts which are identical with those specified be used.

Les normes de sécurité exigent que l'appareil soit remis à l'état d'origine et que soient utilisées les pièces de rechange identiques à celles spécifiées.

CHASSIS ANUBIS A

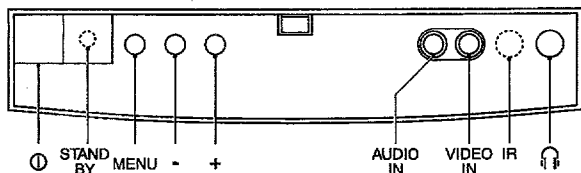

CL 26532210/015
071292

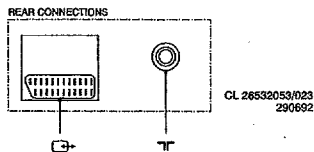

CL 26532053/023
230662

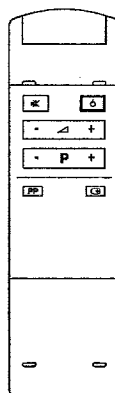

RC 9067
38ZZ3385

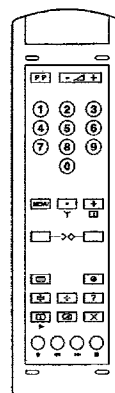

CL 26532210/012
071292

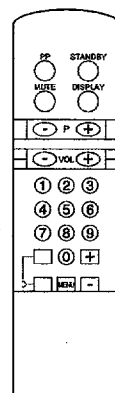

CL 26532210/013
071292

RC6803



220-240 V (± 10%)
50 W



A36EAM11x13
4822 131 20438



axbxc (mm)
370x379x379



1x1 W



-/03/08/09/16: PAL BG

-/39 /38 : PAL BGI
SECAM B/G/L/L'

-/05 : PAL I



UV917E

VHF_a : 46-118 MHz
VHF_b : 118-300 MHz
UHF : 470-861MHz

UV915E

Only for -/38
VHF_a : 46-118 MHz
VHF_b : 118-300 MHz
Hyper : 300-470 MHz
UHF : 470-861 MHz

U943C

Only for -/05
UHF : 470-861MHz

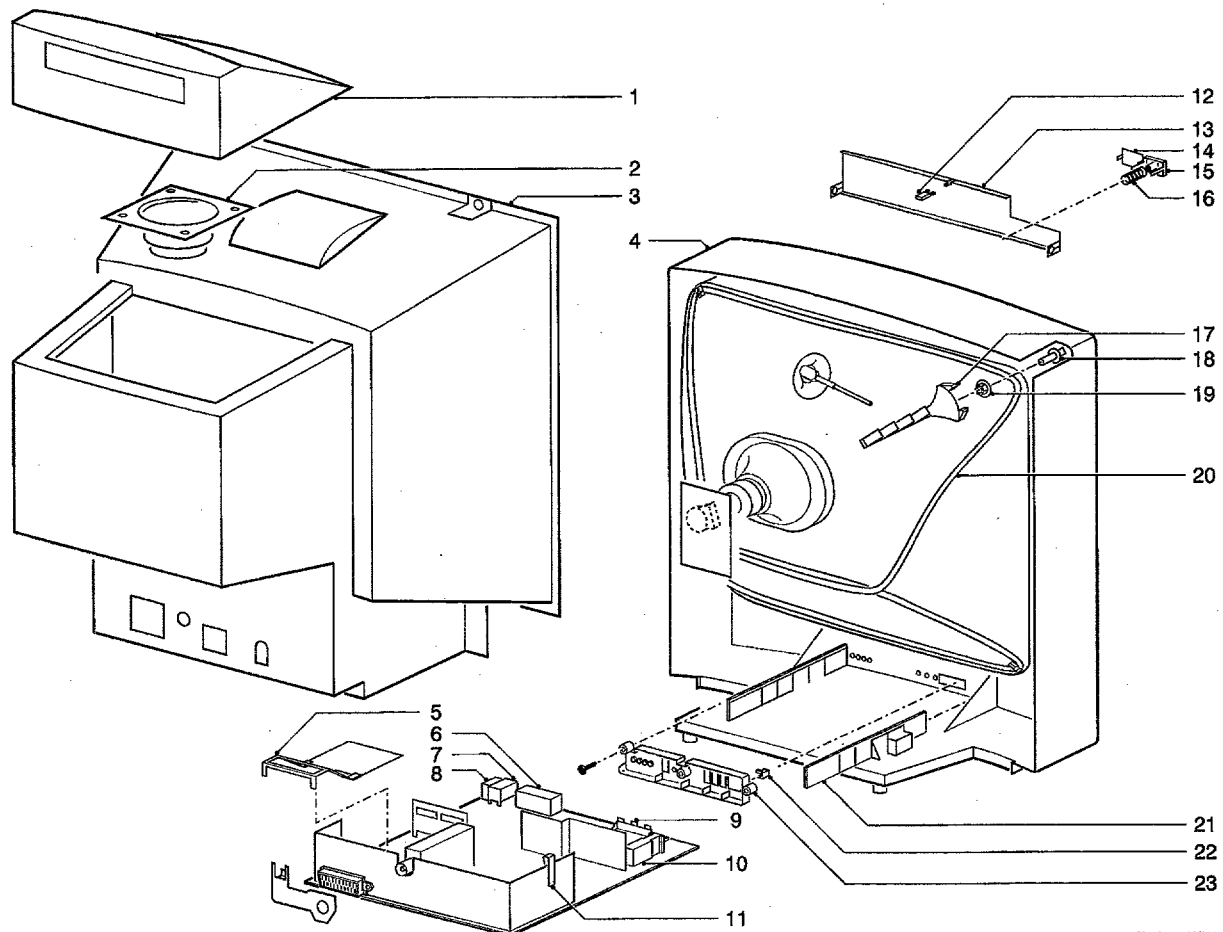

CL 26532210/017
071292

1	4822 445 10348	Loudspeaker box
1	4822 445 10351	Loudspeaker box for 153933PP
2	4822 240 50328	Loudspeaker
3	4822 438 10391	Rear cover
3	4822 438 10417	Rear cover for 153933PP
4	4822 430 10435	Cabinet
4	4822 430 10436	Cabinet for 153933PP
5	4822 403 70874	TXT Bracket
6	4822 205 20626	Phono 2 fold
7	4822 218 20981	Receiver RC 5
8	4822 267 31292	Connector headphones
9	4822 276 13307	Switch assy
10	4822 276 12597	Mains switch
11	4822 492 70559	Spring for transistor
12	4822 278 10088	Locking switch
13	4822 432 93063	Door
13	4822 432 93062	Door for 153933PP
14	4822 381 11401	Lens
15	4822 410 62569	Mains knob
16	4822 492 32656	Spring behind mains knob
17	4822 404 30753	Bracket
18	4822 503 21006	Spindle
19	4822 505 10924	Nut
20	4822 157 51636	Degaussing coil
21	4822 462 30557	Guide
22	4822 462 30567	Lens
23	4822 413 41775	Knob frame
	4822 218 21147	Remote control RC9067N
	4822 218 21155	Remote control RC6803