

Service
Service
Service

17AB3546/00B/01B/13B

21AB3357/01B

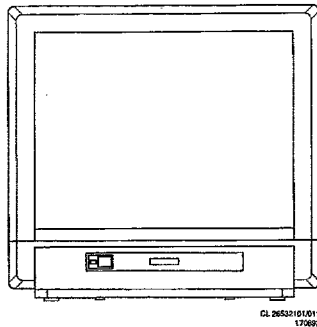

CL 26532101/011
170992

Service Manual

Safety regulations require that the set be restored to its original condition and that parts which are identical with those specified be used.

Les normes de sécurité exigent que l'appareil soit remis à l'état d'origine et que soient utilisées les pièces de rechange identiques à celles spécifiées.

CHASSIS ANUBIS B

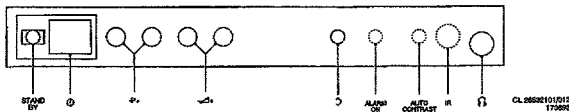

CL 2652101/012
170992

REAR CONNECTIONS

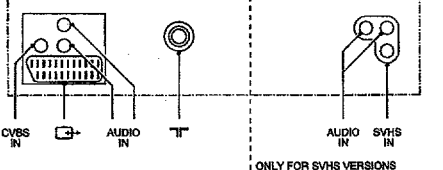

CL 26532101/013
170892

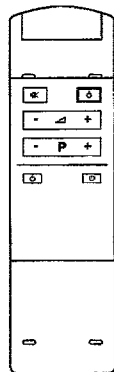

RC9051

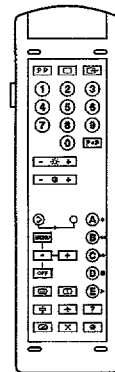

CL 26532093/013
120692

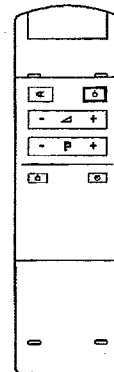

RC9055

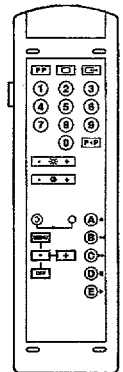

RC 9055
CL 26532154/012
140992



220-240 V (± 10%)
47 W in operation
6 W standby



axbxc (mm)
15": 372x370x386
17": 416x409x410
21": 491x483x484



1x3 W



-/00/ : PAL BG
-/01/13 : PAL BGI
SECAM BGLL'



UV915E
Only for -/01/13
VHFa : 46-118 MHz
VHFb : 118-300 MHz
Hyper : 300-470 MHz
UHF : 470-861 MHz

UV917E
Only for -/00
VHFa : 46-118 MHz
VHFb : 118-300 MHz
UHF : 470-861 MHz



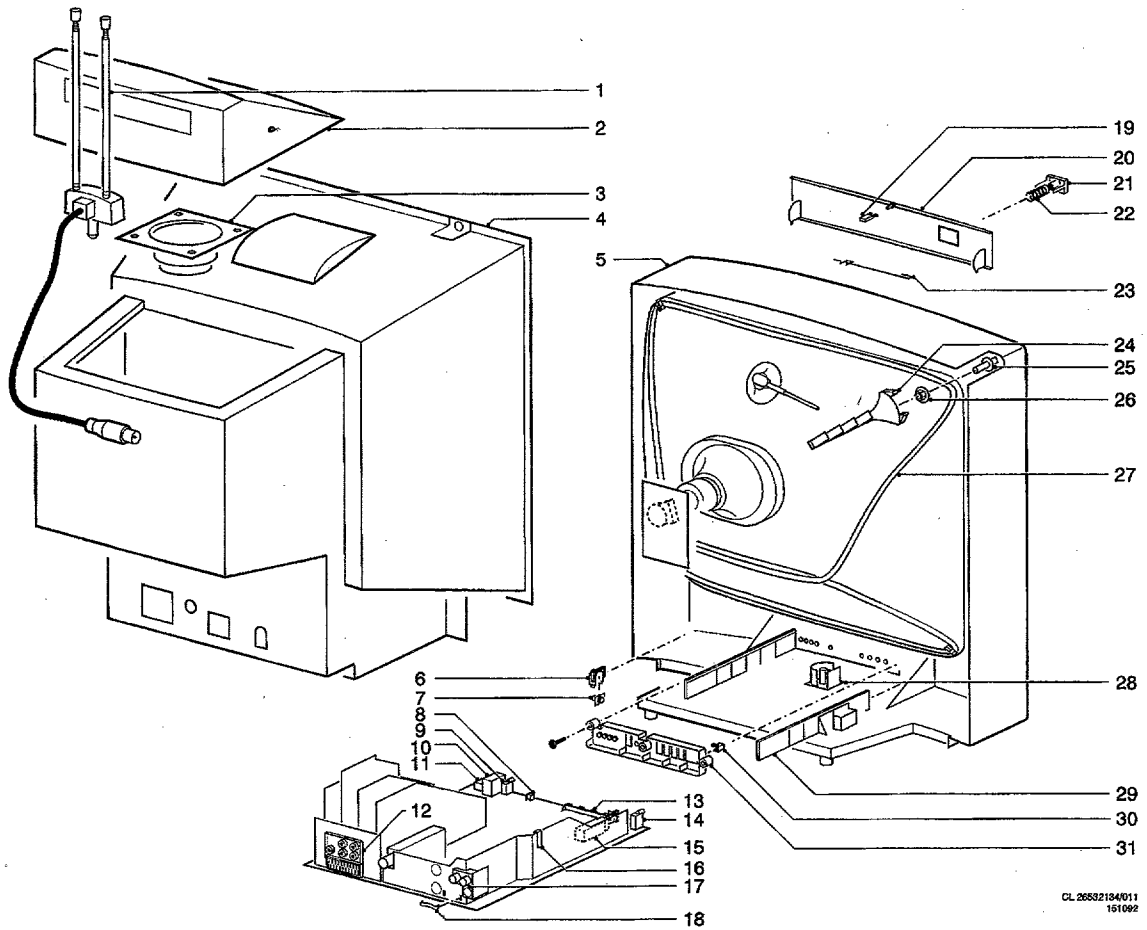

CL 26532104011
151092

- | | | | | | |
|----|----------------|---------------------------------|----|----------------|-----------------------------------------------------|
| 1 | 4822 303 30435 | Aerial not for 21" version | 23 | 4822 492 42628 | Spring for door 15" |
| 2 | 4822 445 10326 | Loudspeaker box 15"/17" | 23 | 4822 492 71148 | Spring for door 17" and 21" |
| 2 | 4822 445 10325 | Loudspeaker box 21" | 24 | 4822 404 30753 | Bracket for Deg. coil 15" |
| 3 | 4822 240 30638 | Loudspeaker | 24 | 4822 404 30839 | Bracket for Deg. coil 17" |
| 4 | 4822 438 10409 | Rear cover 15" | 24 | 4822 404 31238 | Bracket for Deg. coil 21" |
| 4 | 4822 438 20227 | Rear cover 17" | 25 | 4822 503 21006 | Screw for 15"/17" |
| 4 | 4822 438 20228 | Rear cover 21" | 25 | 4822 502 12865 | Spindle for 21" |
| 5 | 4822 430 10429 | Cabinet 15" | 26 | 4822 505 10924 | Nut / washer comb. for 15" |
| 5 | 4822 430 20102 | Cabinet 17" | 26 | 4822 505 10903 | Nut / washer comb. for 17"/; |
| 5 | 4822 430 30209 | Cabinet 21" | 27 | 4822 157 51636 | Degaussing coil 15" |
| 6 | 4822 404 31237 | Bracket for damper | 27 | 4822 157 52323 | Degaussing coil 17" |
| 7 | 4822 522 31741 | Damper | 27 | 4822 157 52155 | Degaussing coil 21" |
| 8 | 4822 276 13269 | Switch 1-fold | 28 | 4822 401 11466 | Pull relief for mains cord
(not for 21" version) |
| 9 | 4822 255 40955 | Holder for LED | 29 | 4822 462 30557 | Guide |
| 10 | 4822 218 20981 | Receiver for RC | 30 | 4822 381 11358 | Lens |
| 11 | 4822 267 31488 | Connector headphones | 31 | 4822 410 62132 | Knob frame |
| 12 | 4822 267 20428 | Scart +3 cinch | | | |
| 12 | 4822 267 20435 | Scart +3 cinch for /00 versions | | | |
| 13 | 4822 277 21438 | Switch 4-fold | | | |
| 14 | 4822 256 91918 | Holder for standby LED | | | |
| 15 | 4822 276 12597 | Mains switch | | 4822 321 10885 | Mains cord for -/00/01 versic |
| 16 | 4822 492 70559 | Spring for transistor | | 4822 321 10814 | Mains cord for -/13 versions |
| 17 | 4822 267 20387 | Only for SVHS versions | | 4822 131 20438 | Picture tube A36EAM11X13 |
| 18 | 4822 492 70788 | Spring for IC | | 4822 131 20407 | Picture tube A41EAM11X13 |
| 19 | 4822 278 10088 | Locking mechanism | | 4822 131 20324 | Picture tube A51EAM31X45 |
| | | | | 4822 218 21092 | Remote control RC9051 |
| | | | | 4822 218 21136 | Remote control RC9055 PH
for 21" |
| 20 | 4822 432 93046 | Door 15" | | | |
| 20 | 4822 432 93019 | Door 17" | | | |
| 20 | 4822 432 92979 | Door 21" | | | |
| 21 | 4822 410 62129 | Mains knob | | | |
| 22 | 4822 492 32656 | Spring behind mains knob | | | |