

Service
Service
Service

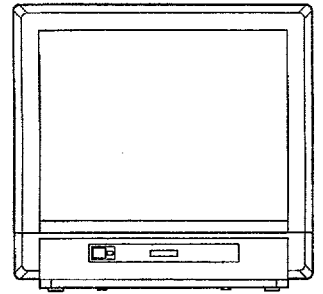

CL 26532053/022
290692

Service Manual

Safety regulations require that the set be restored to its original condition and that parts which are identical with those specified be used.

Les normes de sécurité exigent que l'appareil soit remis à l'état d'origine et que soient utilisées les pièces de rechange identiques à celles spécifiées.

CHASSIS ANUBIS A

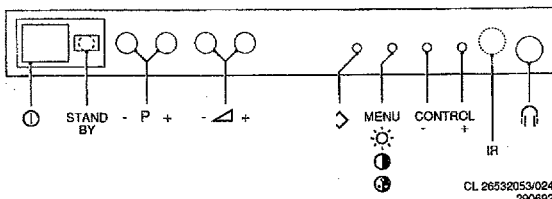

CL 26532053/024
290692

REAR CONNECTIONS

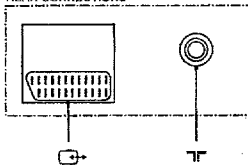

CL 26532053/023
290692

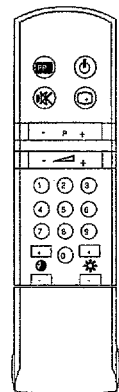

RC6802.DCM

RC6802



220-240 V (± 10%)
50 W



A36EAM11X13
4822 131 20438

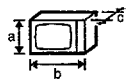

axbxc
370x378x386 mm



1x1W



-/00 : PAL BG
-/01 : PAL BGI
SECAM LL'
-/05 : PAL I



UV917E
Only for -/00
VHFa : 46-118 MHz
VHFb : 118-300 MHz
UHF : 470-861 MHz
U943C
Only for -/05
UHF : 470-861 MHz
UV915E
Only for -/01
VHFa : 46-118 MHz
VHFb : 118-300 MHz
Hyper : 300-470 MHz
UHF : 470-861 MHz



PHILIPS

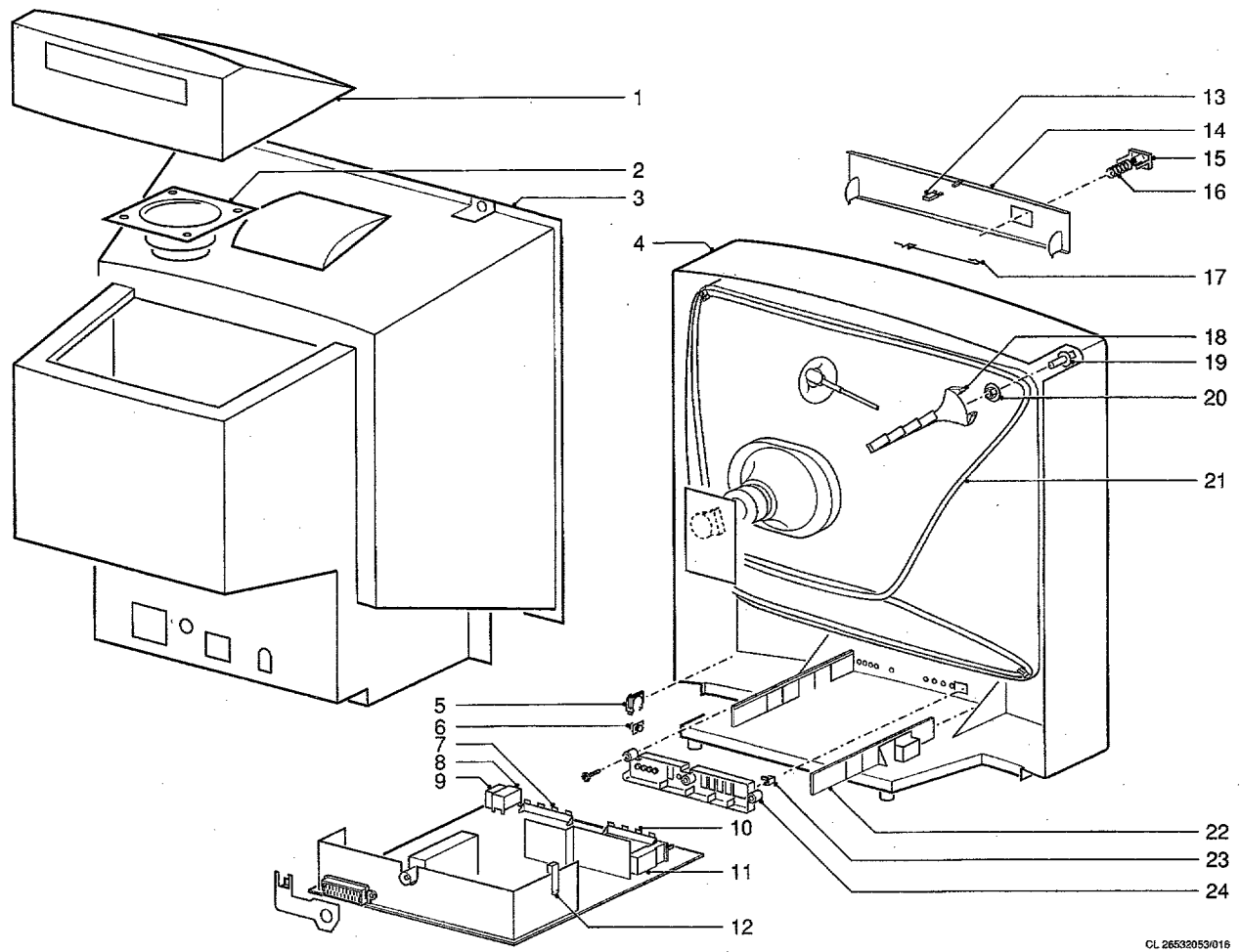

CL 26532053/016
240692

- | | | |
|----|----------------|-------------------------|
| 1 | 4822 445 10326 | Loudspeaker box 15"/17" |
| 2 | 4822 240 50328 | Loudspeaker |
| 3 | 4822 438 10391 | Rear cover 15" |
| 4 | 4822 430 10397 | Cabinet 15" |
| 5 | 4822 404 31237 | Holder for damper |
| 6 | 4822 522 31741 | Damper |
| 7 | 4822 276 40414 | Switch assy right |
| 8 | 4822 218 20981 | RC5 Receiver |
| 9 | 4822 267 31292 | Headphone jack |
| 10 | 4822 277 21438 | Switch assy left |
| 11 | 4822 276 12597 | Mains switch |
| 12 | 4822 492 70559 | Spring for transistor |
| 13 | 4822 278 10088 | Lock mechanism |
| 14 | 4822 432 92982 | Door 15" |
| 15 | 4822 410 62199 | Mains button |
| 16 | 4822 492 32656 | Spring |
| 17 | 4822 492 42628 | Spring for door |
| 18 | 4822 404 30753 | Bracket |
| 19 | 4822 503 21006 | Spindle |
| 20 | 4822 505 10924 | Nut |
| 21 | 4822 157 51636 | Degaussing coil 15"/17" |
| 22 | 4822 462 30557 | Guide |
| 23 | 4822 381 11362 | LED lens |
| 24 | 4822 410 62202 | Button frame |
| | 4822 218 21038 | Remote control RC6802 |
| | 4822 303 40057 | Aerial |