

AMERICAN VINTAGE II 1966 JAZZ BASS® (0190170XXX)

PARTS LAYOUT

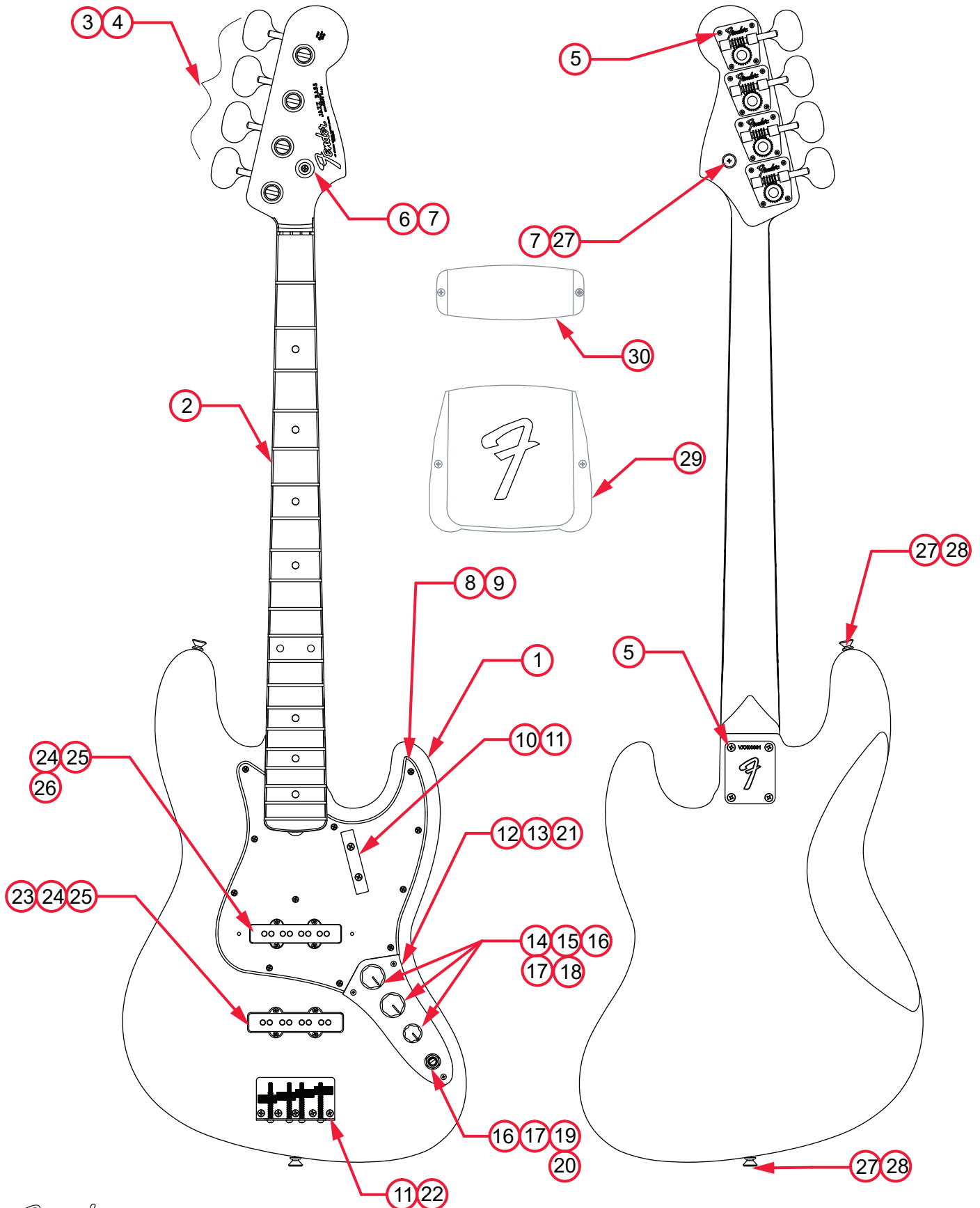

AMERICAN VINTAGE II 1966 JAZZ BASS® (0190170XXX)

PARTS LIST

REF#	DESCRIPTION	PART NUMBER
1	BODY AM VINT 64 J-BASS 3TSB	7723077500
1	BODY AM VINT 64 J-BASS OWT	7723076505
1	BODY AM VINT 64 J-BASS SFMG	7723076549
2	NECK AM VINT II 66 J-BASS RW	7721554000
2	NECK AM VINT II 66 J-BASS RW OWT HDCP	7721586000
2	NECK AM VINT II 66 J-BASS RW SFMG HDCP	7721585000
3	KEY HB2 OVAL CHR M FENDER LOGO C/S W/BUSHING	0072260020
4	SCREW SMAB 3 X 3/8 RHP NI	0011357049
5	SCREW SMA 8 X 1-3/4 OHP NI	0015636049
6	STRING GUIDE 60'S AM VINT	0095422000
7	SCREW SMA 5 X 5/8 OHP NI	0015602049
8	PICKGUARD VINT J-BASS BROWN SHELL	7723074000
9	SCREW SMAB 4 X 1/2 OHP NI	0015578049
10	THUMB REST	0992036000
11	SCREW SMAB 5 X 1 OHP NI	0015610049
12	CONTROL PLATE 64 JAZZ BASS CHROME	0099512000
13	SCREW SMAB 3 X 1/2 THP NI	0019672049
14	KNOB VINTAGE SKIRTED SET (1 SMALL 2 LARGE)	0992085000
*15	CONTROL 250K 10%	0990831000
*16	NUT HEX 3/8-32 X 3/32 TK NI	0016352049
*17	WASHER LOCK INTL 3/8 X .687	0016436049
18	CAPACITOR WAX PAPER .05µF 150V	0096454049
19	JACK PHONE OPEN CIRCUIT 11	0021956049
20	WASHER FLAT 3/8 X .614 NI	0031153049
21	CONTROL SHIELD BLANK	0010694020
22	BRIDGE ASSY P/J BASS CHROME	0990804100
22A	BRIDGE PLATE JAZZ BASS	0010538070
22B	BRIDGE SECTION VINTAGE BASS	0019469000
22C	SET SCREW 6-32 X 7/16 OVPT SL NI	0016105049
22D	SCREW M 6-32 X 1-1/2 RHP NI	0015842049
22E	SPRING COMPRESSION 1-1/16 #144	0018689049
23	PICKUP ASSY 66 J-BASS BRIDGE	7721556000
24	SCREW 4 X 1-1/4 WOOD RD PH NI	0027035049
25	SHIELD PICKUP 62 J-BASS	0019662000
26	PICKUP ASSY 66 J-BASS NECK	7721555000

*= NOT PICTURED IN DIAGRAM



AMERICAN VINTAGE II 1966 JAZZ BASS® (0190170XXX)

REF#	DESCRIPTION	PART NUMBER
27	STRAP BUTTON NI .156	0994915000
28	SCREW WOOD 6 X 1 OHP NI	0016188049
29	BRIDGE COVER CHROME J-BASS	0010678000
30	COVER PICKUP STEEL CHROME J-BASS	0010660090
*	CASE J-BASS BLACK	0050879011

*= NOT PICTURED IN DIAGRAM



AMERICAN VINTAGE II 1966 JAZZ BASS® (0190170XXX)

WIRING ASSEMBLY

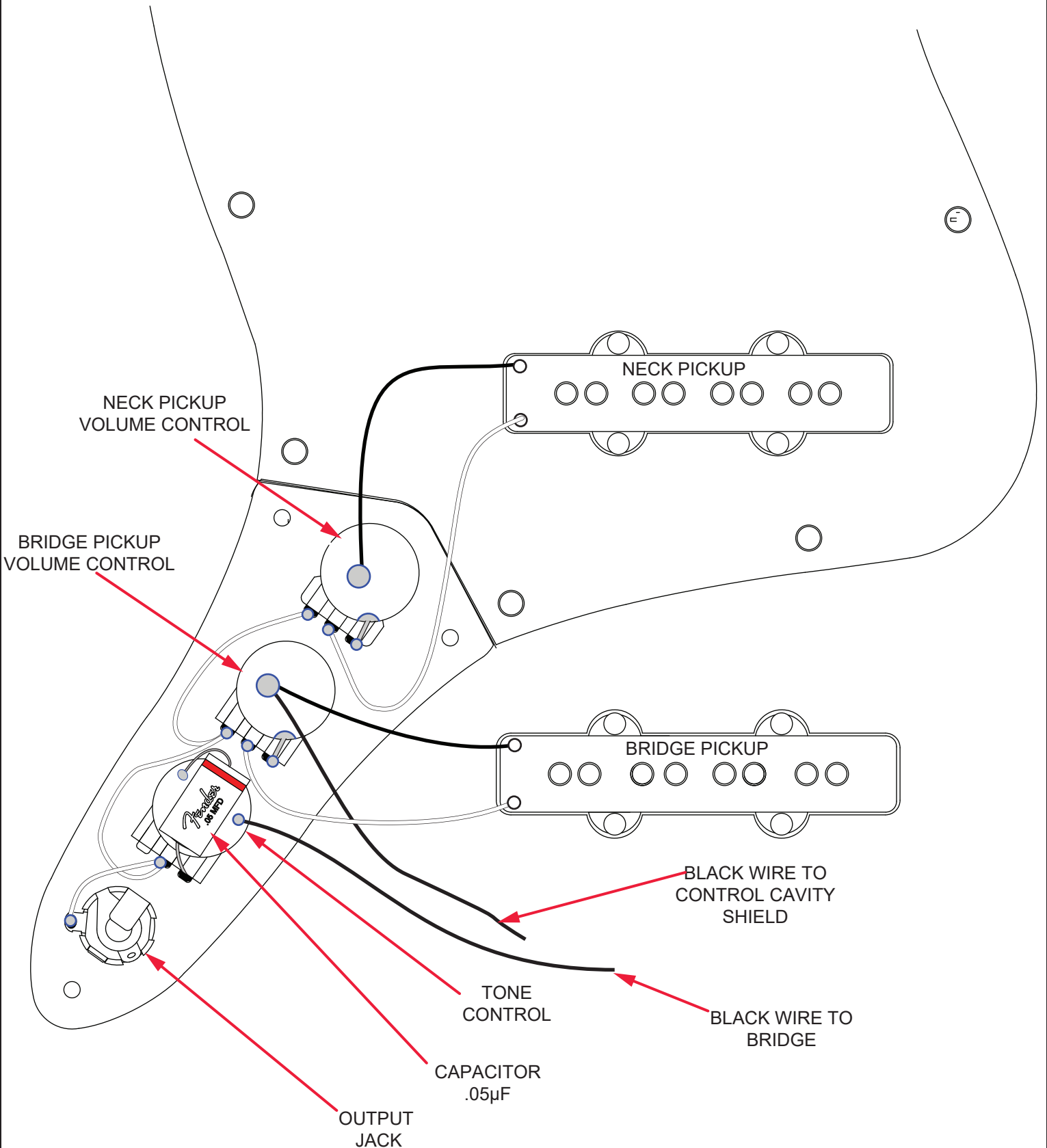

AMERICAN VINTAGE II 1966 JAZZ BASS® (0190170XXX)

GROUND WIRE LOCATIONS

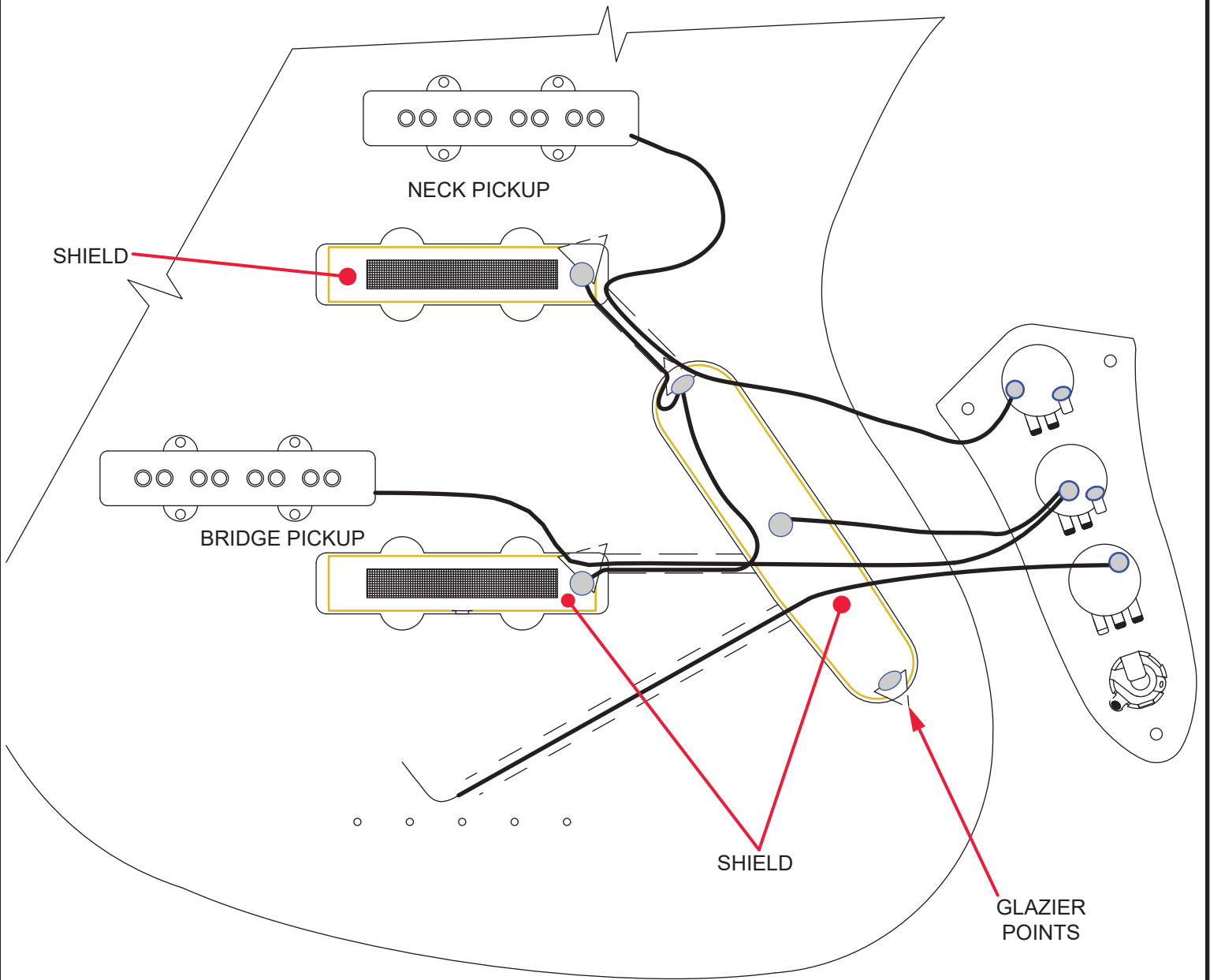

AMERICAN VINTAGE II 1966 JAZZ BASS® (0190170XXX)

SWITCH AND CONTROL FUNCTION

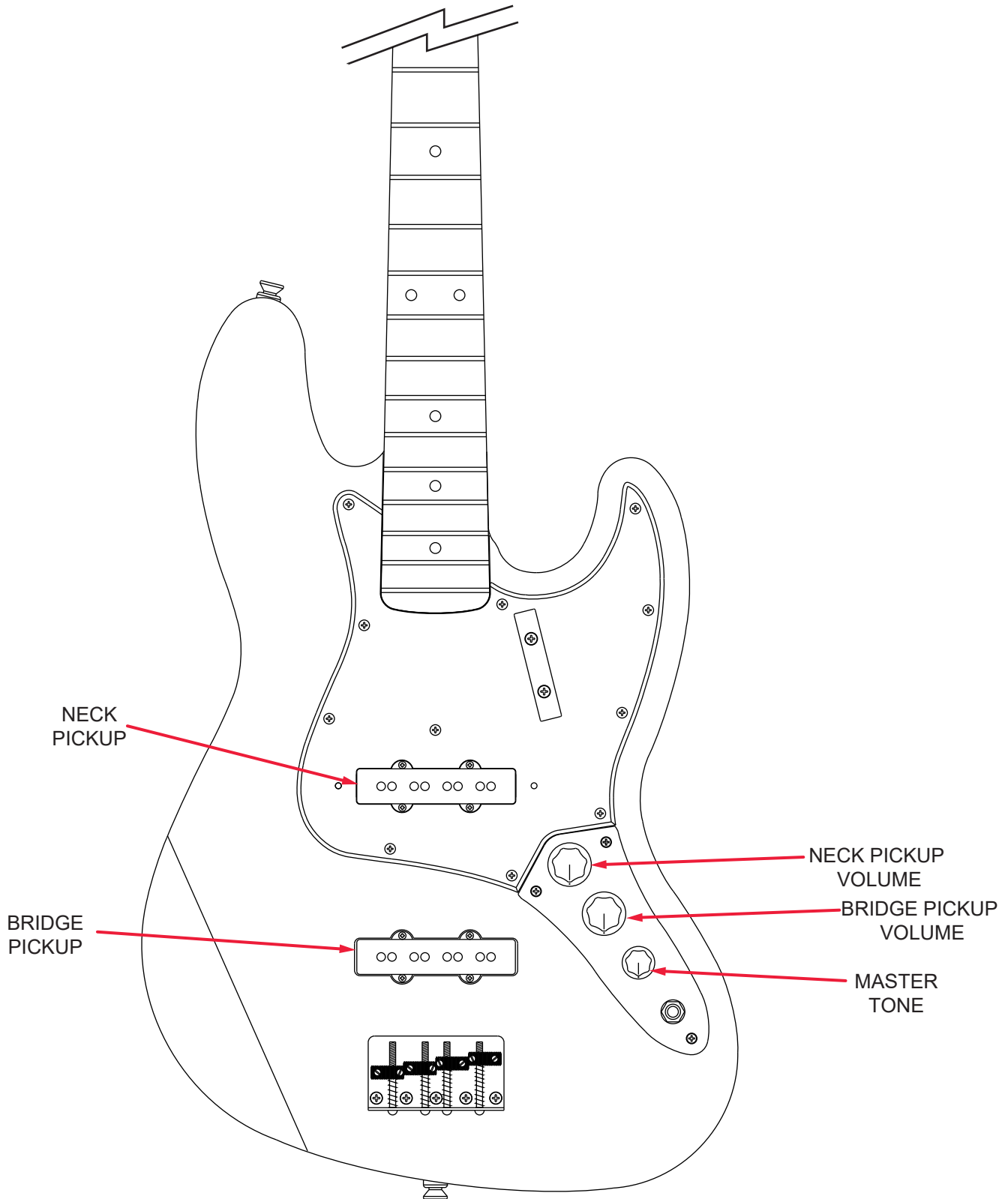

AMERICAN VINTAGE II 1966 JAZZ BASS® (0190170XXX)

ADDITIONAL SPECIFICATION DETAIL

FRET SIZE: VINTAGE
(FRET DIMENSIONS ARE BEFORE INSTALLATION)

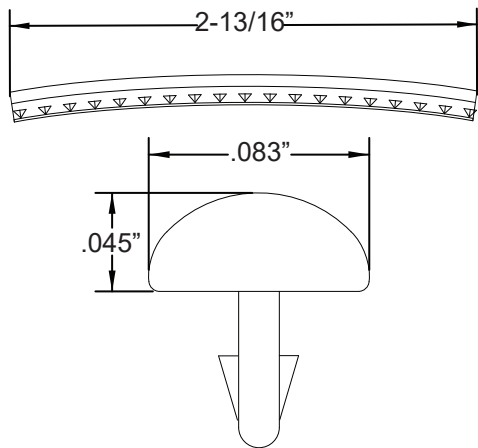

PLEASE NOTE: AS EACH NECK IS SANDED & FINISHED BY HAND, THICKNESS DIMENSIONS MAY VARY SLIGHTLY FROM THOSE SHOWN.

NECK PROFILE: VINTAGE "C"

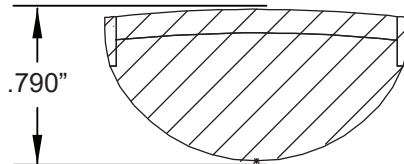

1ST FRET PROFILE

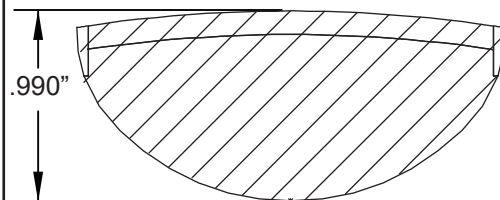

12TH FRET PROFILE

TUNING MACHINE W/BUSHING: P/N 0072260020
OUTER SHAFT DIAMETER .540"

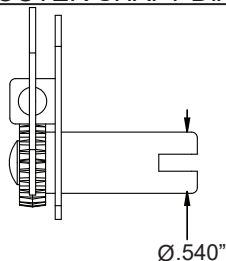

TUNING MACHINE THRU-HOLE
INNER DIAMETER .675"

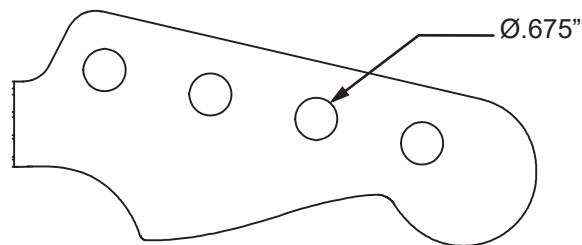

SADDLE HEIGHT ADJUSTMENT SCREWS: P/N 0016105049

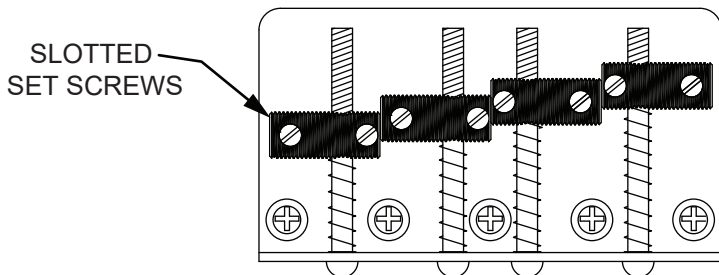

TRUSS ROD ADJUSTMENT NUT:
P/N 0058171000

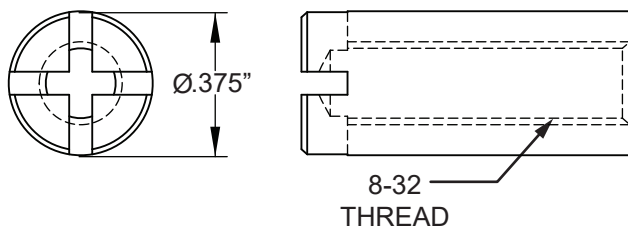

LOGO: VINTAGE 64 JAZZ BASS
APPLIED OVER THE FINISH



PICKUP SPECIFICATIONS

POSITION	MAGNETS	DC RESISTANCE	POLARITY
NECK	ALNICO 5 UNBEVELED	6.7 - 7.3KΩ	SOUTH
BRIDGE	ALNICO 5 UNBEVELED	6.7 - 7.3KΩ	NORTH