

# Technical Manual

# JBL M121-8

## SPECIFICATIONS

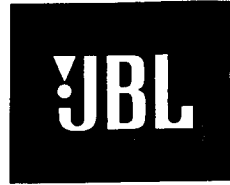

### ACOUSTIC & ELECTRICAL SPECIFICATIONS:

- Nominal Impedance: 8 ohm
- Power Capacity: 300W AES Shaped Noise
- Frequency Range: 60 Hz to 6000 Hz ( $\pm 10$ dB)
- Sensitivity: 102 dB SPL\*
- Crossover Frequencies: N/A

### SYSTEM COMPONENTS:

- Cabinet: N/A
- Grille: N/A
- Low Frequency Transducer: 300mm (12 in.) Cone Transducer (M121-8)
- DC Resistance: 5.2 ohm  $\pm 10\%$  - Aluminum Wire

### AURAL SWEEP TEST SPECIFICATIONS:

- A. System Aural Sweep Test: 7.0V Input, 20 Hz to 20 kHz
- B. L.F. Aural Sweep Test: 7.0V Input, 20 Hz to 1.2 kHz

### PHYSICAL SPECIFICATIONS:

- Enclosure Dimensions: 311mm x 311mm x 147mm D (12.25 x 12.25 x 5.81 in. D)
- Shipping Weight: 16 lbs. (7.3 kg)

### WARRANTY INFORMATION:

- Refer to the Warranty Statement packed with each product.

\*1 Watt (2.83 V RMS) @ 1 Meter

## PACKAGE

Warranty 59660  
Specification Sheet 73480  
Logo 73795  
Under Pad

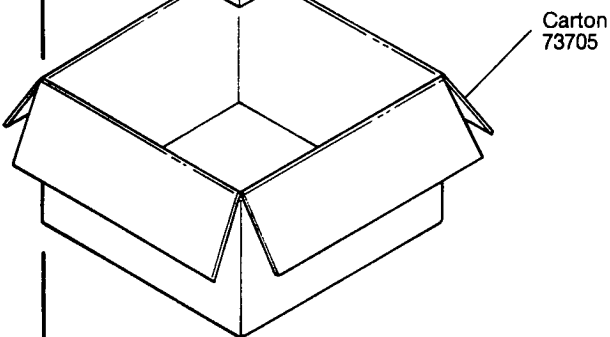
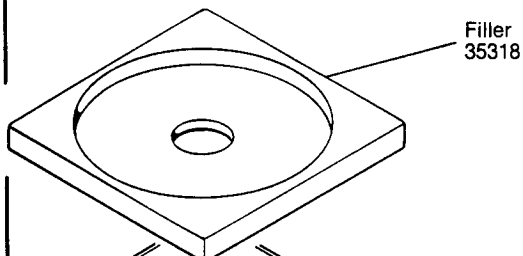
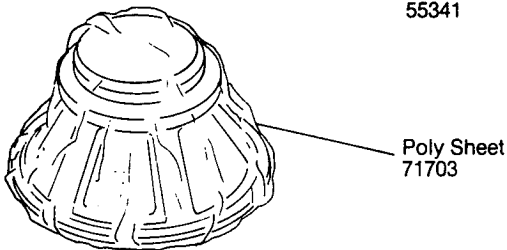
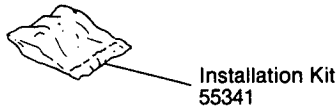

## COMPONENT VIEW

Speaker, Low Freq  
M121-8  
Cone Repl  
C8RM121

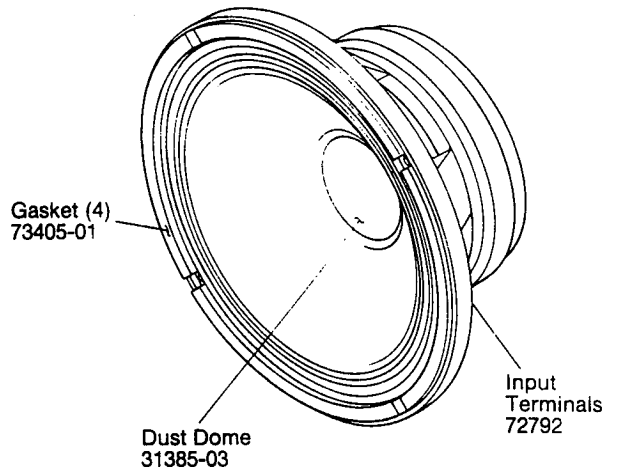
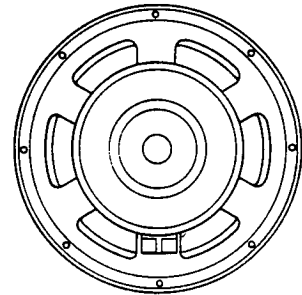

# JBL M121-8

## MECHANICAL DRAWING

THESE DRAWINGS AND SPECIFICATIONS ARE THE PROPERTY OF JBL, INCORPORATED. THEY ARE ISSUED IN STRICT CONFIDENCE AND SHALL NOT BE REPRODUCED, COPIED, OR USED AS THE BASIS FOR MANUFACTURE OR SALE OF APPARATUS WITHOUT WRITTEN PERMISSION.

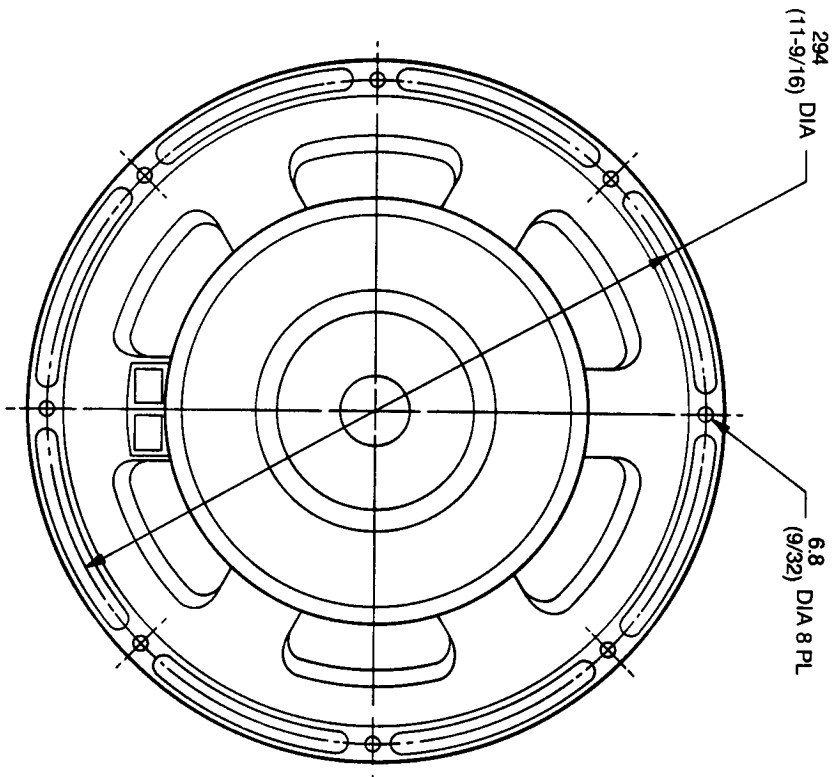
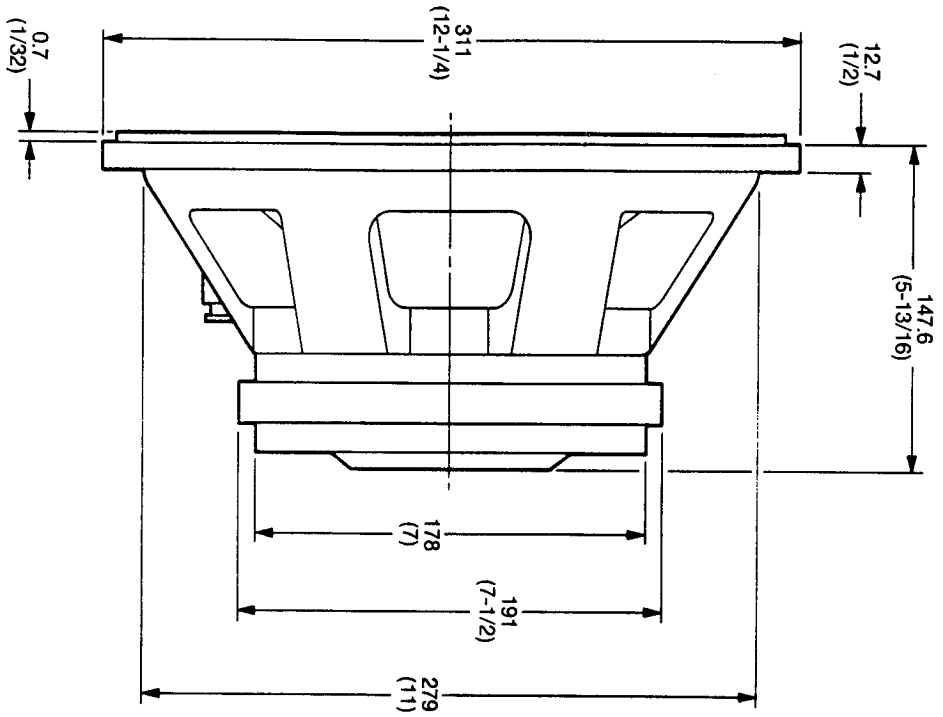

NOTE: DIMENSIONS IN ( ) ARE INCHES

JBL M121-8