

# Technical Manual



# JBL4731A HIGH POWER 2-WAY DIRECT RADIATOR SOUND REINFORCEMENT/PLAYBACK SYSTEM

## SPECIFICATIONS

### ACOUSTIC & ELECTRICAL SPECIFICATIONS:

- Nominal Impedance: 8 ohm
- Power Rating: 600W IEC
- Frequency Response: 60 Hz to 16 kHz ( $\pm$  3dB)
- Sensitivity: 97 dB SPL\*
- Crossover Frequencies: 900 Hz

### SYSTEM COMPONENTS:

- Cabinet: C4731A
- Grille: G4731A
- Low Frequency Transducer: 380mm (15 in.) Paper Cone Transducer (2226H)

\*1 Watt (2.83 V RMS) @ 1 Meter

### SYSTEM COMPONENTS: (cont'd)

- High Frequency Transducer: 25mm (1 in.) Pure Titanium Compression Driver (2426J)
- Crossover Network: N4731A

### PHYSICAL SPECIFICATIONS:

- Enclosure Dimensions: 850mm x 565mm x 440mm D (33.46 x 22.24 x 17.31 in. D)
- Shipping Weight: 90 lbs. (41 kg)

### WARRANTY INFORMATION:

- Refer to the Warranty Statement packed with each product.

## WIRING DIAGRAM

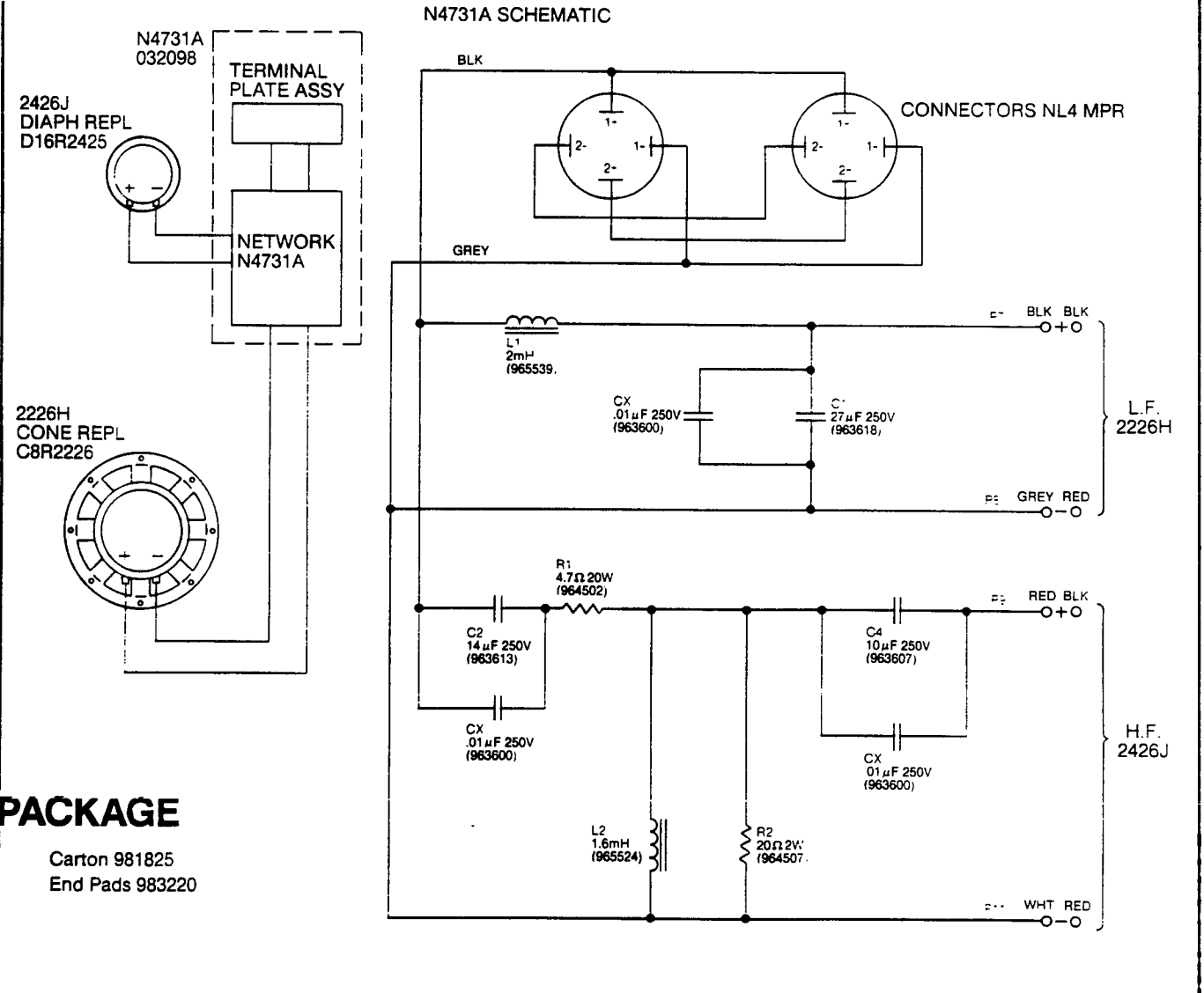

## PACKAGE

Carton 981825  
End Pads 983220

JBL4731A REV B

# JBL4731A

## COMPONENT EXPLODED VIEW

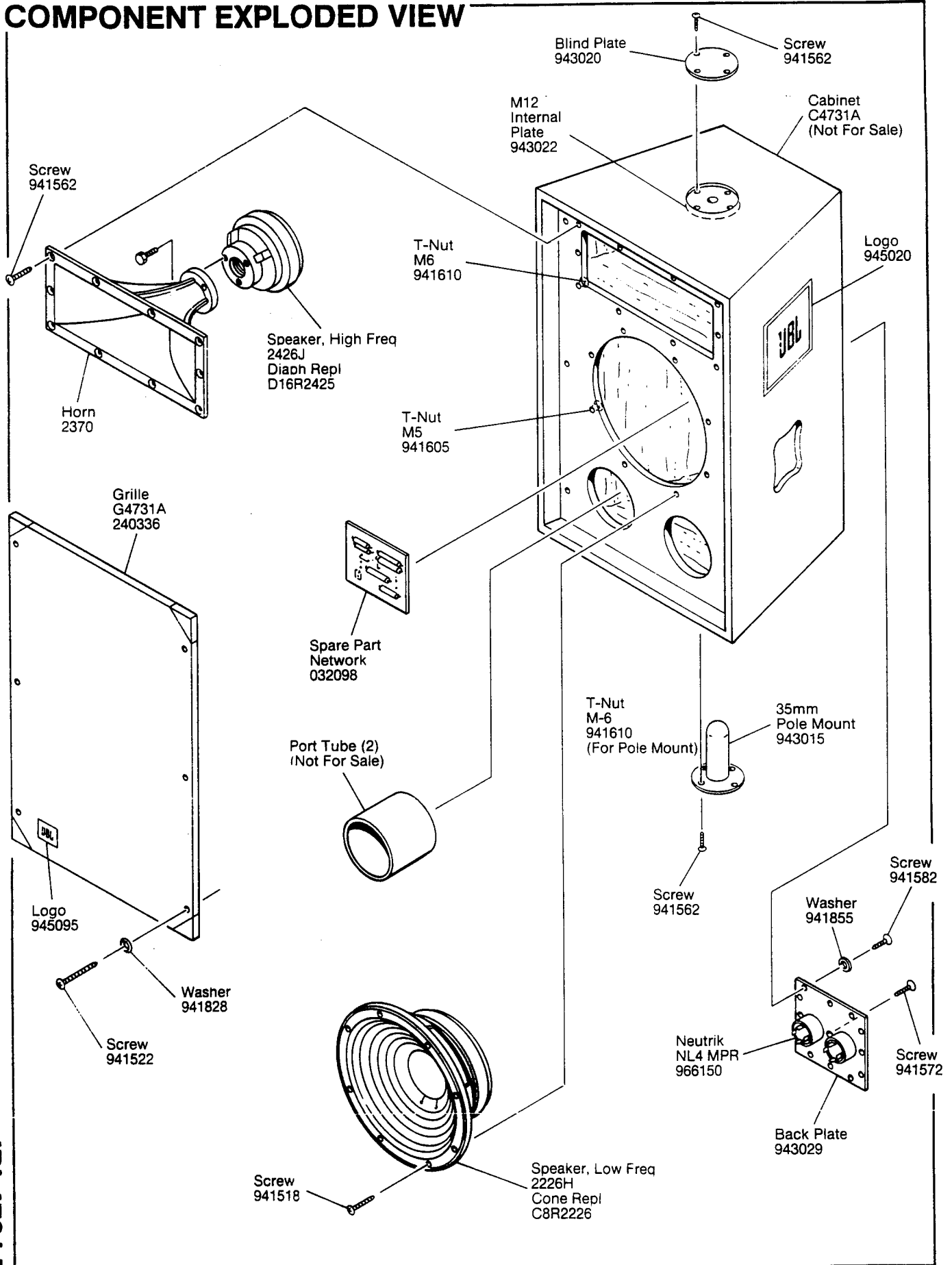

JBL4731A