

4

3

2

1

REVISION					
REV	ECO	ZONE	DESCRIPTION	DATE	APPROVED
01			PROTOTYPE	12/03/03	
A			PRODUCTION RELEASE	04/05/04	
B	10053		CHANGED INDUCTANCE & HI-POT TEST VALUES	04/27/04	
C	10105		CHANGED WIRE WRAPPING DETAILS, NOTE 8, ADDED "TURNS PER SIDE" COLUMN	12/22/04	
D	10134		CHANGED INDUCTANCE TOLERANCE ON -001	4/8/05	

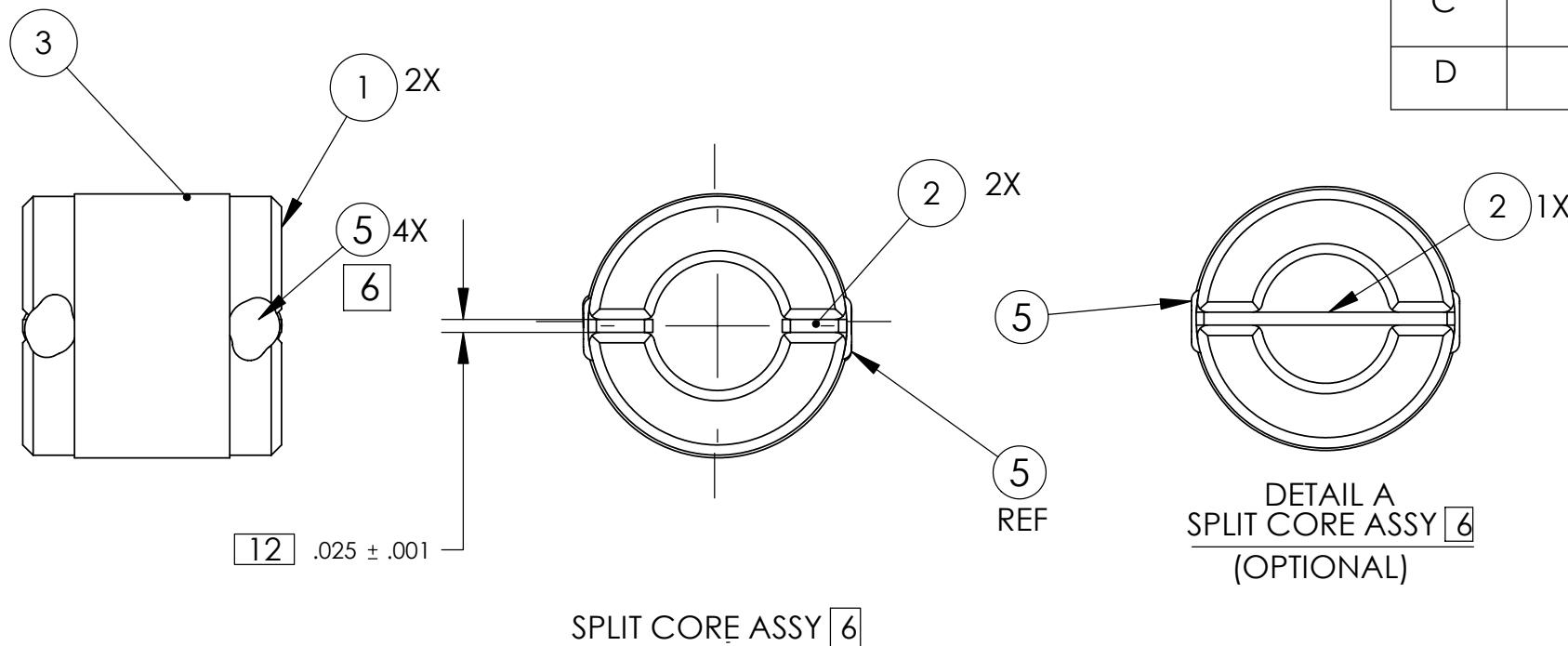

NOTES (UNLESS OTHERWISE SPECIFIED):

MATERIAL:

- 1. ALL INSULATING MATERIALS USED IN THE CONSTRUCTION OF THIS ITEM SHALL BE UL RECOGNIZED CLASS B INSULATION, AND BE APPROVED BY D2AUDIO ENGINEERING.
- 2. AN AUTHORIZED MATERIAL CERTIFICATION OF COMPLIANCE SPECIFYING MATERIAL TYPE, MANUFACTURER, AND UL RECOGNITION CLASS MUST BE SUPPLIED WITH EACH SHIPMENT AND REFERENCED BY PURCHASE ORDER NUMBER.

SPECIFICATION AND ACCEPTANCE TEST:

- 3. SEE SPECIFICATION CHART AT RIGHT FOR INDUCTANCE SPECIFICATION.
- 4. INDUCTANCE MEASURE AT FREQ: 1.0KHZ, MODE: SERIES, DRIVE: 100MA, TEMP: 25° C.
- 5. HI-POT TEST: 200Vrms @ 60HZ, 1 SEC.

CONSTRUCTION: (ALTERNATE METHODS NOT SPECIFIED IN THIS DRAWING SHALL BE APPROVED BY D2AUDIO ENGINEERING):

- 6. ASSEMBLE AND BRIDGE - BOND ITEM 1, CORES, AND ITEM 2, SPACER USING EPOXY ADHESIVE, ITEM 5. WRAP CORE WITH TAPE, ITEM 3. SPLIT CORE ASSY METHOD, DETAIL A, MAY BE USED AT SUPPLIERS OPTION.
- 7. SEE SPECIFICATION CHART FOR NUMBER OF TURNS (-001 IS SHOWN ON DRAWING). WINDING DIRECTION SHALL MATCH THAT SHOWN ON SHEET 2. TURNS ARE COUNTED AS THOSE THAT PASS THRU THE CENTER OF THE TOROID.
- 8. BEGIN WINDING TO ONE SIDE OF FRONT CORE GAP CONTINUING PAST REAR GAP AND BACK TO OPPOSITE SIDE OF FRONT GAP. WINDING MUST BE SINGLE LAYER. WIND THE WIRE SO THAT IT WILL BE DENSELY WRAPPED ABOUT THE CENTER OF EACH CORE HALF, AS SHOWN ON SHT. 2.. COMPLY WITH 0.078 WIRE-TO-GAP DISTANCE AS SHOWN. WIRE PATH WILL CROSS THE REAR GAP AND CONTINUE THE SAME WINDING PATTERN ON THE SECOND HALF, AS SHOWN.
- 9. FOLD ONE LEAD OVER TAPE SO THAT IT POINTS IN SAME DIRECTION AS THE OTHER LEAD, BOTH BEING LOCATED AT THE OUTSIDE DIAMETER OF THE TOROID AS INDICATED ON SHEET 2.
- 10. WRAP CORE WITH TAPE, ITEM 3.
- 11. STRIP AND TIN LEADS AS SHOWN, BEING CAREFUL NOT TO NICK OR GOUGE THE WIRE.
- 12. SPACE (GAP) BETWEEN SPLIT CORE SURFACES.

IDENTIFICATION AND PACKAGING:

- 13. PACK AND MARK EACH CONTAINER D2AUDIO PART NUMBER, REVISION, D2AUDIO VENDOR CODE, AND DATE CODE.
- 14. SUPPLIER TO PACKAGE ITEM TO AFFORD PROTECTION FROM DAMAGE.

DASH #	INDUCTANCE μH	WIRE GAUGE	# OF TURNS	# OF TURNS PER SIDE
-002	80 +/- 5%	26 AWG	42	21
-001	15.65 +10%/ -5%	22 AWG	18	9

SPECIFICATION CHART

ITEM	QTY	PART NO.	DESCRIPTION
5	AR	CONAPOXY AD-10 OR EQUIV.	ADHESIVE, EPOXY, HEAT OR UV CURE
4	AR	NEMA MW.28-C HEAVY BUILD	WIRE, MAGNET
3	AR	3M #1318 OR EQUIV.	TAPE, POLY FILM
2	AR	NOMEX 410 OR EQUIV.	SPACER, INSULATING
1	2	D2A 0701-000002-001	CORE, SPLIT FERRITE TOROID

PARTS LIST

UNLESS OTHERWISE SPECIFIED DIMENSIONS ARE IN INCHES		PROJECT		D2AUDIO
TOLERANCES ARE:		ATTWOOD 2 INDUCTORS		
FRACTIONAL	DECIMAL	ANGULAR	APPROVALS	DATE
X ± 1/32	XX ± 0.01	± 1°	DRAWN	NLC 12/2/03
	XXX ± 0.005		CHECKED	
MATERIAL SEE NOTES		APPROVED		VENDOR CONTROL DRAWING INDUCTOR, GAPPED FERRITE TOROID
NEXT ASSY USED ON		FINISH		SIZE DWG NO. 0701-000001-000
APPLICATION DO NOT SCALE DRAWING				SCALE: 3:1 FILE NAME SHEET 1 OF 2

PROPRIETARY NOTICE
THIS DRAWING IS THE PROPERTY OF D2 AUDIO CORP. AND IS TO BE RETURNED UPON DEMAND OR TERMINATION OF THE TRANSACTION FOR WHICH IT WAS FURNISHED. USE OF ANY INFORMATION CONTAINED ON THIS DRAWING FOR ANY PURPOSE OTHER THAN EXPRESSLY AUTHORIZED IN WRITING BY D2 AUDIO CORP. IS PROHIBITED.

4

3

2

1

4 3 2 1

D D

C C

B B

A A

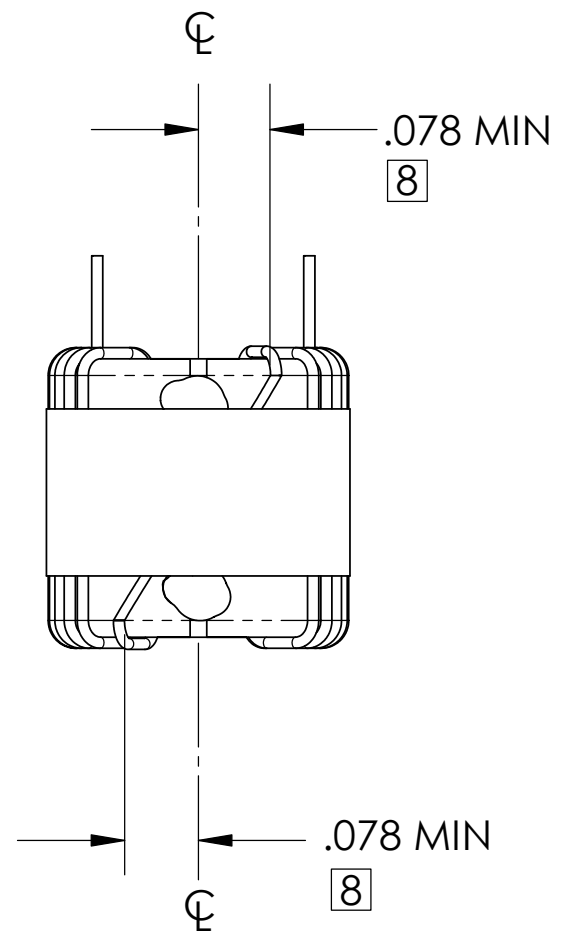
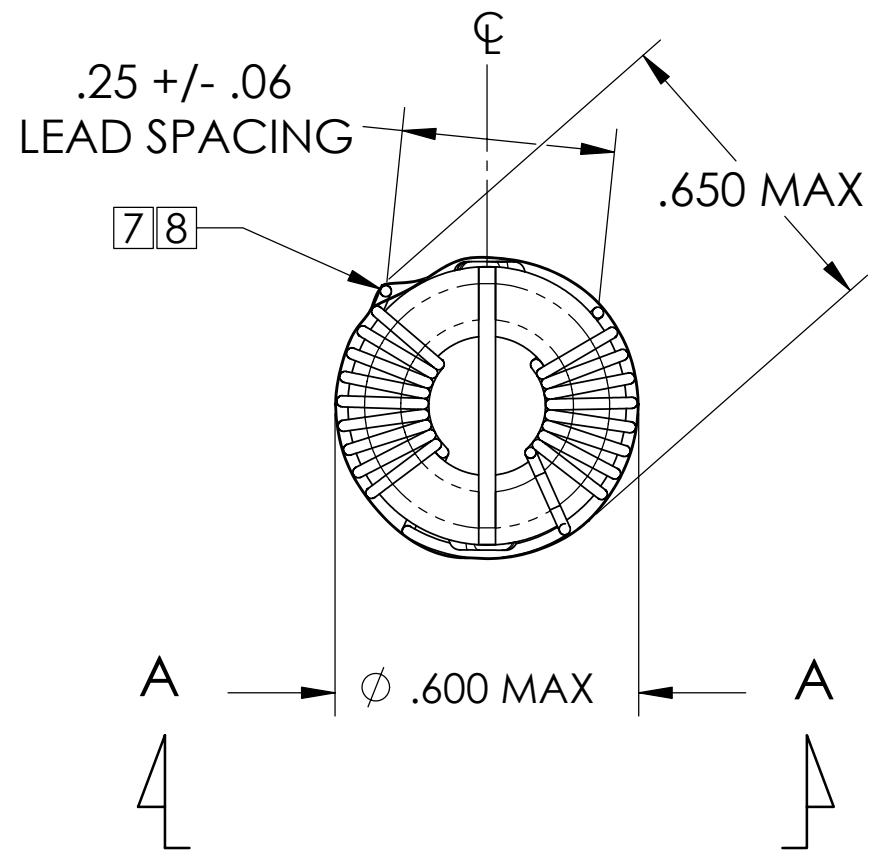
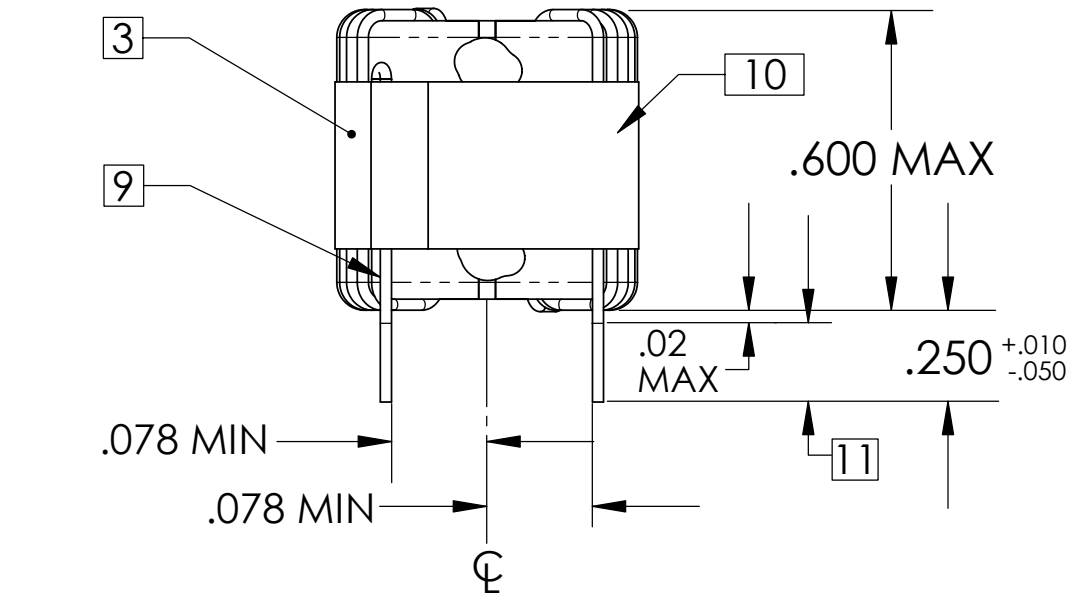

VIEW A-A

D2AUDIO

VENDOR CONTROL DRAWING
INDUCTOR, GAPPED FERRITE TOROID

SIZE	DWG. NO.	REV.
B	0701-000001-000	D
SCALE: 3:1	FILE NAME	SHEET 2 OF 2

4 3 2 1